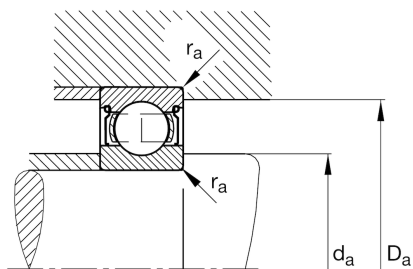
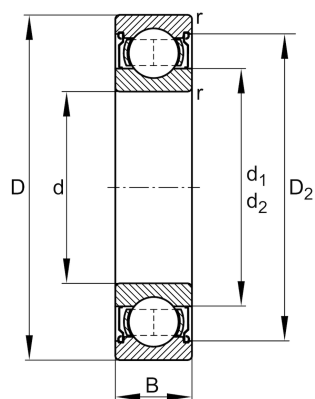
**FAG****6311-2Z**

Deep groove ball bearing

Schaeffler ID:
0167237590000Deep groove ball bearing 63...-2Z, single
row, shields, steel sheet metal cage

Technical information

**Dimensions**

r_{\min}	2 mm	Minimum chamfer dimension
D_2	104.3 mm	Caliber diameter outer ring
d_1	75.2 mm	Shoulder diameter inner ring
	1.375 kg	Weight

Main Dimensions & Performance Data

d	55 mm	Bore diameter
D	120 mm	Outside diameter
B	29 mm	Width
C_r	83,000 N	Basic dynamic load rating, radial
C_{0r}	47,500 N	Basic static load rating, radial
C_{ur}	3,250 N	Fatigue load limit, radial
n_G	7,200 1/min	Limiting speed
n_{gr}	7,100 1/min	Reference speed

Mounting dimensions

$d_{a \min}$	66 mm	Minimum diameter shaft shoulder
$D_{a \max}$	109 mm	Maximum diameter of housing shoulder
$r_{a \max}$	2 mm	Maximum fillet radius

Calculation factors

f_0	12.9	Calculation factor
-------	------	--------------------

Temperature range

T_{\min}	-20 °C	Operating temperature min.
T_{\max}	120 °C	Operating temperature max.